



**DEPARTMENT OF THE NAVY**  
JOINT BASE PEARL HARBOR-HICKAM  
850 TICONDEROGA ST STE 100  
PEARL HARBOR HI 96860-5102

5090  
Ser JB4/1047  
28 Sep 2020

From: Commander, Joint Base Pearl Harbor-Hickam  
To: Staff and Patrons of Joint Base Pearl Harbor-Hickam Hickam Youth Center (Building 1335H)

Subj: SAMPLING AND TESTING FOR LEAD IN DRINKING WATER AT HICKAM YOUTH CENTER

Ref: (a) OPNAVINST 5090.1E, Environmental Readiness Program

Encl: (1) Overview of Testing Results and Corrective Actions for Hickam Youth Center (Building 1335H)

1. I am pleased to report that all water intended for consumption at this Youth Center (YC) has tested below the Environmental Protection Agency's (EPA's) lead screening level of 15 parts per billion (ppb). Initial results identified that one outlet at Hickam YC did not meet EPA's lead screening level. Shortly after receiving the initial results, we took the outlet out of service and performed corrective actions. Follow-up sampling identified that the outlet at Hickam YC is now compliant with EPA's lead screening level and no further action is required. Enclosure 1 of this letter provides a summary of all sampling results for the entire facility.

2. These tests are conducted every 5 years, and samples are taken from all sources water used for drinking, cooking, or washing at all YCs and Child Development Centers (CDCs). Our latest tests were conducted in December 2019.

3. Per reference (a), we have adopted the EPA's recommendation that we test the lead content of drinking water in priority areas such as YCs and CDCs as policy and made this a top priority. Our environmental personnel conducted this testing following Navy and EPA guidelines, and samples were sent to a state-certified or accredited laboratory for analysis.

4. My team and I will continue to monitor and test water quality at all of our YCs and CDCs to ensure our water is safe to drink and use. I remain committed to the safety and health of all personnel and family members using our facilities and will keep you updated as necessary.

5. If you have questions regarding the sampling program, please contact our Installation Environmental Program Director at (808) 474-0392 or [steven.christiansen@navy.mil](mailto:steven.christiansen@navy.mil).

R. E. HARMEYER  
CAPT, CEC, U.S. Navy  
By direction

Copy:  
CNIC N45  
CNRH N45  
NAVFAC HI EV, EV1, PRJ4

## Overview of Testing Results and Corrective Actions for Hickam Youth Center (Building 1335H)

At the Hickam Youth Center, outlets used for drinking, cooking, and washing were tested. Out of 36 samples collected, one water outlet initially tested above the screening level of 15 parts per billion (ppb) for lead in drinking water in schools and childcare centers.

The first sampling event took place on November 16, 2019. We received the test results on December 15, 2019 which included one exceedances. We took that outlet out of service shortly after and conducted follow up sampling on December 11, 2019 to verify the result. Summary table of the results from the first and follow-up samples for the one outlet:

Outlet ID#	Outlet Description	First Sample (ppb)	Follow-up Sample (ppb)		Comments and Corrective Actions
			First Draw	Flush	
38	Mens Bathroom (Soccer Field)	30	9.6	9.0	Most likely source of lead was from infrequent use of the sink. Water should be run for 30 sec in the morning.

A complete summary results table (enclosure 2) is enclosed for your information. The *Building #* and *Room #* indicate the location of the fixture. The *Outlet Map #* corresponds to the location indicated on the floor plan of the CDC (enclosure 3). The *Category* column gives information about whether the outlet is used for drinking water (water fountain), cooking (food preparation), or washing (primarily hand-washing or brushing teeth). The *Outlet Description* column contains additional information to describe the outlet. The next set of columns provide *Initial Lead Results*, and for those locations that exceeded the recommended screening level of 15 ppb the *Follow-up Lead Results*.

EPA sampling protocol requires water to not be used for between 8 and 18 hours prior to first draw sampling. Therefore, *Initial Lead Results* were from first draw samples collected early in the morning before the CDC opened and before any water was used. The *Initial Lead Results* also indicate whether resampling is required.

The *Follow-up Lead Results* includes columns for *First Draw* and *Flush* samples, which help determine the source of lead:

- If the lead concentration of 30 second flush sample resulted in lower than 15 ppb lead, the aerators were the source of lead and the outlet can be used for drinking if the aerators are cleaned on a regular basis.
- If the lead concentration of the resampled first draw (but not the follow up 30 second flush) was greater than 15 ppb, the fixture was the source of lead. These fixtures can be used if water is flushed for 30 seconds before first use of the day or if the fixtures are replaced and retesting confirms that the new fixtures do not leach lead.
- If the lead concentration of the sample following the 30 second flush was greater than 15 ppb and greater than the lead concentration of the first draw resample, the source of lead is the plumbing upstream of the outlet. These outlets should be disconnected unless upstream plumbing is replaced.

The *Comments* column indicates additional information regarding the fixture and actions to remediate the source of lead if detected.

**LIPA Test Results**  
**JBPHH - Youth Center (Building # 1335H)**

Initial Sample Date: 11/16/19, Results Date: 12/05/19  
 Follow-up Sample Date: 12/11/19, Results Date: 12/27/19

Building #	Room #	Outlet Map #	Category	Outlet Description	Initial Lead Results (ppb)	Follow-up Lead Results (ppb)		Comments
						First Draw	Flush	
1333H	Exterior	36	Drinking	Water Fountain - Bubbler	0.72	Not Sampled	Not Sampled	Used for special events/soccer
1333H	Mens Bathroom	38	Washing	Adult Sink	30	9.6	9	Most likely source of lead was from infrequent use of the sink. Water should be run for 30 sec in the morning
1333H	Womens Bathroom	37	Washing	Adult Sink	11	Not Sampled	Not Sampled	Used for special events/soccer
1335H	Arts & Craft	29	Washing	Toddler Sink	1.3	Not Sampled	Not Sampled	
1335H	Boys Bathroom	4	Washing	Toddler Sink	1.4	Not Sampled	Not Sampled	
1335H	Boys Bathroom	5	Washing	Toddler Sink	3.6	Not Sampled	Not Sampled	
1335H	Boys Bathroom	6	Washing	Toddler Sink	0.99	Not Sampled	Not Sampled	
1335H	Boys Bathroom	17	Washing	Toddler Sink	2.1	Not Sampled	Not Sampled	
1335H	Chill Zone	28	Drinking	Water Fountain - Cooler	Not Detected	Not Sampled	Not Sampled	
1335H	Design Studio	30	Washing	Toddler Sink	1.8	Not Sampled	Not Sampled	
1335H	Exterior	25	Washing	Adult Sink	Not Detected	Not Sampled	Not Sampled	
1335H	Exterior	27	Washing	Hose Bib	Not Detected	Not Sampled	Not Sampled	
1335H	Exterior	31	Washing	Hose Bib	0.77	Not Sampled	Not Sampled	
1335H	Exterior	35	Washing	Hose Bib	Not Detected	Not Sampled	Not Sampled	Used for waterplay
1335H	Girls Bathroom	1	Washing	Toddler Sink	1.2	Not Sampled	Not Sampled	
1335H	Girls Bathroom	2	Washing	Toddler Sink	1.2	Not Sampled	Not Sampled	
1335H	Girls Bathroom	3	Washing	Toddler Sink	0.86	Not Sampled	Not Sampled	
1335H	Girls Bathroom	18	Washing	Toddler Sink	3	Not Sampled	Not Sampled	
1335H	Gym	19	Drinking	Water Fountain - Bubbler	7.5	Not Sampled	Not Sampled	
1335H	Kitchen	20	Washing	Kitchen Sink	Not Detected	Not Sampled	Not Sampled	
1335H	Kitchen	21	Washing	Kitchen Sink	0.54	Not Sampled	Not Sampled	
1335H	Kitchen	22	Washing	Kitchen Sink	1.4	Not Sampled	Not Sampled	
1335H	Kitchen	23	Washing	Kitchen Sink	0.59	Not Sampled	Not Sampled	
1335H	Kitchen	24	Drinking	Ice Machine	Not Detected	Not Sampled	Not Sampled	

Building #	Room #	Outlet Map #	Category	Outlet Description	Initial Lead Results (ppb)	Follow-up Lead Results (ppb)		Comments
						First Draw	Flush	
1335H	Mens Bathroom	7	Washing	Adult Sink	0.78	Not Sampled	Not Sampled	
1335H	Mens Bathroom	8	Washing	Adult Sink	Not Detected	Not Sampled	Not Sampled	
1335H	Mens Bathroom	9	Washing	Adult Sink	2.9	Not Sampled	Not Sampled	
1335H	Mens Bathroom	10	Washing	Adult Sink	3.5	Not Sampled	Not Sampled	
1335H	Mens Bathroom	11	Washing	Adult Sink	2	Not Sampled	Not Sampled	
1335H	Womens Bathroom	12	Washing	Adult Sink	0.7	Not Sampled	Not Sampled	
1335H	Womens Bathroom	13	Washing	Adult Sink	0.54	Not Sampled	Not Sampled	
1335H	Womens Bathroom	14	Washing	Adult Sink	Not Detected	Not Sampled	Not Sampled	
1335H	Womens Bathroom	15	Washing	Adult Sink	Not Detected	Not Sampled	Not Sampled	
1335H	Womens Bathroom	16	Washing	Adult Sink	0.78	Not Sampled	Not Sampled	
1335H	West of Gym	33	Washing	Water Fountain - Cooler	1.2	Not Sampled	Not Sampled	
1335H	West of Gym	34	Washing	Water Fountain - Cooler	1.4	Not Sampled	Not Sampled	
1335H	Exterior	32	Washing	Water Fountain - Bubbler	Not Sampled	Not Sampled	Not Sampled	Fountain removed
1335H	Exterior	HB-1	Washing	Hose Bib	Not Sampled	Not Sampled	Not Sampled	Landscaping only
1335H	Exterior	HB-2	Washing	Hose Bib	Not Sampled	Not Sampled	Not Sampled	Landscaping only
1335H	Exterior	HB-3	Washing	Hose Bib	Not Sampled	Not Sampled	Not Sampled	Landscaping only
1335H	Exterior	HB-4	Washing	Hose Bib	Not Sampled	Not Sampled	Not Sampled	Landscaping only
1335H	Exterior	HB-5	Washing	Hose Bib	Not Sampled	Not Sampled	Not Sampled	Landscaping only
1335H	Exterior	HB-6	Washing	Hose Bib	Not Sampled	Not Sampled	Not Sampled	Landscaping only
1335H	Laundry Room	US-1	Washing	Utility Sink	Not Sampled	Not Sampled	Not Sampled	Cleaning only
1335H	Custodian Room	US-2	Washing	Utility Sink	Not Sampled	Not Sampled	Not Sampled	Cleaning only

(EPA Limit is 15 ppb)

TRUE NORTH  
NOT TO SCALE

BLDG 1333 (SEE NOTE)

NOTE  
BLDG 1333 KEPT LOCKED. ONLY USED FOR SPECIAL EVENTS (ONCE ANNUALLY) AND SOCCER SEASON.

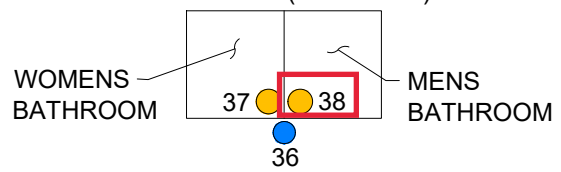

SOCCER FIELD

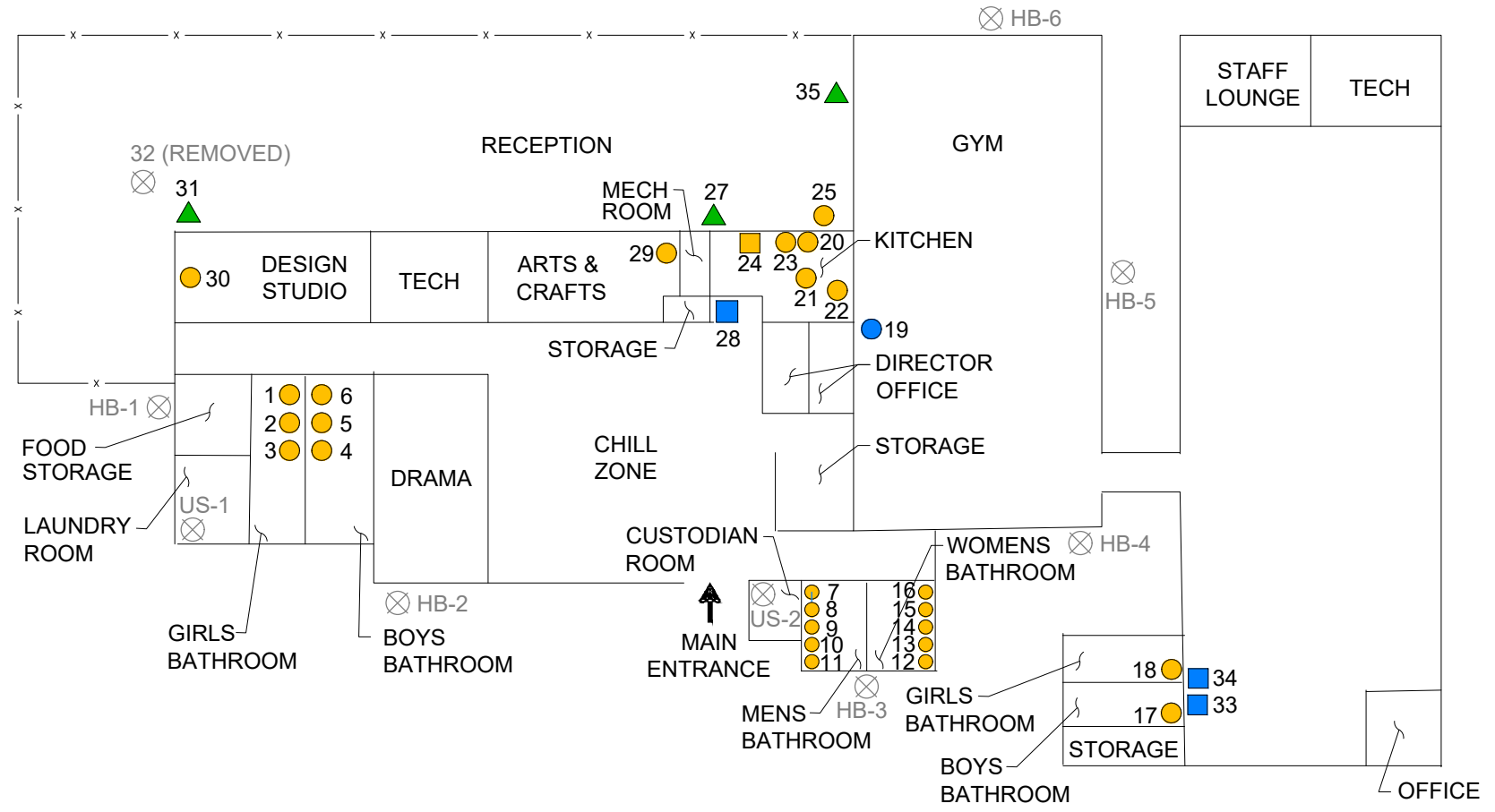

**LEGEND**

- SINK FAUCET
- DRINKING FOUNTAIN (BUBBLER)
- DRINKING FOUNTAIN (COOLER)
- ▲ HOSE BIB
- ICE MACHINE
- X WATER OUTLET (FIXTURE REMOVED OR NON-CONSUMABLE USE)

Enclosure (3)

	DATE: DEC 2019	PROJECT TITLE: LEAD IN DRINKING WATER TESTING AT PRIORITY AREAS AT JBPHH AND NCTAMS, PACIFIC
	FIGURE TITLE: HICKAM, YOUTH CENTER (BLDGS 1333H, 1335H) - SAMPLE LOCATIONS	
		FIGURE NO.: 3