

**Priority Areas Lead Testing and Corrective Action
Kinnick High School- Bldgs 3365 (Community Readiness Center 2nd Floor) 2020 Test Results**

Table 1. Summary of Results

| SAMPLE LOCATION DESCRIPTION | | | INITIAL FULL BUILDING SAMPLING RESULTS | | | RE-SAMPLING RESULTS | | POST REMEDIATION SAMPLING RESULTS | | CORRECTIVE ACTIONS |
|---------------------------------|-----------------------|----------------------|--|------------------|-----------------------|--|------------------|--|------------------|--------------------|
| CATEGORY Water Intended For: | SAMPLE ID | Outlet Description | First Draw (ppb) | Retest required? | Date Fixture Secured? | Recommended Level = 15ppb | | | | Description |
| | | | | | | Water Fountain 15 min. Follow up Flush Sample - Collected day before First Draw Sampling (ppb) | First Draw (ppb) | Follow up Flush Collected 30 seconds after First Draw Sampling (ppb) | First Draw (ppb) | |
| SAMPLING DATE | | | 3/25/2020 | | | - | - | - | - | |
| RESULTS DATE | | | 4/27/2020 | | | - | - | - | - | |
| Drinking | YSK3365C001 (Rm 202) | Cooler | 1.1 | No | - | - | - | - | - | - |
| Drinking | YSK3365C002 (Rm 202) | Cooler | 1.2 | No | - | - | - | - | - | - |
| Washing | YSK3365F003 (Rm 201A) | Motion Sensor Faucet | 1.2 | No | - | - | - | - | - | - |
| Washing | YSK3365F004 (Rm 202B) | Motion Sensor Faucet | 1.1 | No | - | - | - | - | - | - |
| Cooking/Brushing | YSK3365F005 (Rm 214) | Faucet | 1.1 | No | - | - | - | - | - | - |
| Cooking/Brushing | YSK3365F007 (Rm 226) | Faucet | 1.5 | No | - | - | - | - | - | - |
| Drinking | YSK3365C008 (Rm 202) | Cooler | 0.74 | No | - | - | - | - | - | - |
| Drinking | YSK3365C009 (Rm 202) | Cooler | non-detect | No | - | - | - | - | - | - |
| Washing | YSK3365F010 (Rm 227) | Motion Sensor Faucet | 2.5 | No | - | - | - | - | - | - |
| Washing | YSK3365F011 (Rm 227) | Motion Sensor Faucet | 1.3 | No | - | - | - | - | - | - |
| Washing | YSK3365F012 (Rm 227)* | Motion Sensor Faucet | - | - | - | - | - | - | - | - |
| Washing | YSK3365F014 (Rm 228)* | Motion Sensor Faucet | - | - | - | - | - | - | - | - |
| Washing | YSK3365F015 (Rm 228) | Motion Sensor Faucet | 1.6 | No | - | - | - | - | - | - |
| Washing | YSK3365F016 (Rm 228)* | Motion Sensor Faucet | - | - | - | - | - | - | - | - |
| Drinking | YSK3365F018 (Rm 209) | Faucet | 5.1 | No | - | - | - | - | - | - |

Notes :

*Outlet was out of order and unable to collect samples. Samples will be collected upon completion of repair.

Table 2. Summary Statistics

| CATEGORY | INITIAL SAMPLING RESULT | RE-SAMPLING RESULTS | | | POST REMEDIATION RESULTS | |
|---|-------------------------|--|------------------|--|--------------------------|--|
| | First Draw (ppb) | Water Fountain Follow up Flush Sample - Collected day before First Draw Sampling (ppb) | First Draw (ppb) | Follow up Flush - Collected 30 seconds after First Draw Sampling (ppb) | First Draw (ppb) | Follow up Flush - Collected 30 seconds after First Draw Sampling (ppb) |
| Total Drinking | 5 | 0 | 0 | 0 | 0 | 0 |
| Total Drinking > 20 ppb | 0 | 0 | 0 | 0 | 0 | 0 |
| Total Cooking/Brushing | 2 | 0 | 0 | 0 | 0 | 0 |
| Total Cooking/Brushing > 20 ppb | 0 | 0 | 0 | 0 | 0 | 0 |
| Total Washing | 5 | 0 | 0 | 0 | 0 | 0 |
| Total Washing > 20 ppb | 0 | 0 | 0 | 0 | 0 | 0 |
| Total Samples | 12 | 0 | 0 | 0 | 0 | 0 |
| Total Samples > 20 ppb | 0 | 0 | 0 | 0 | 0 | 0 |

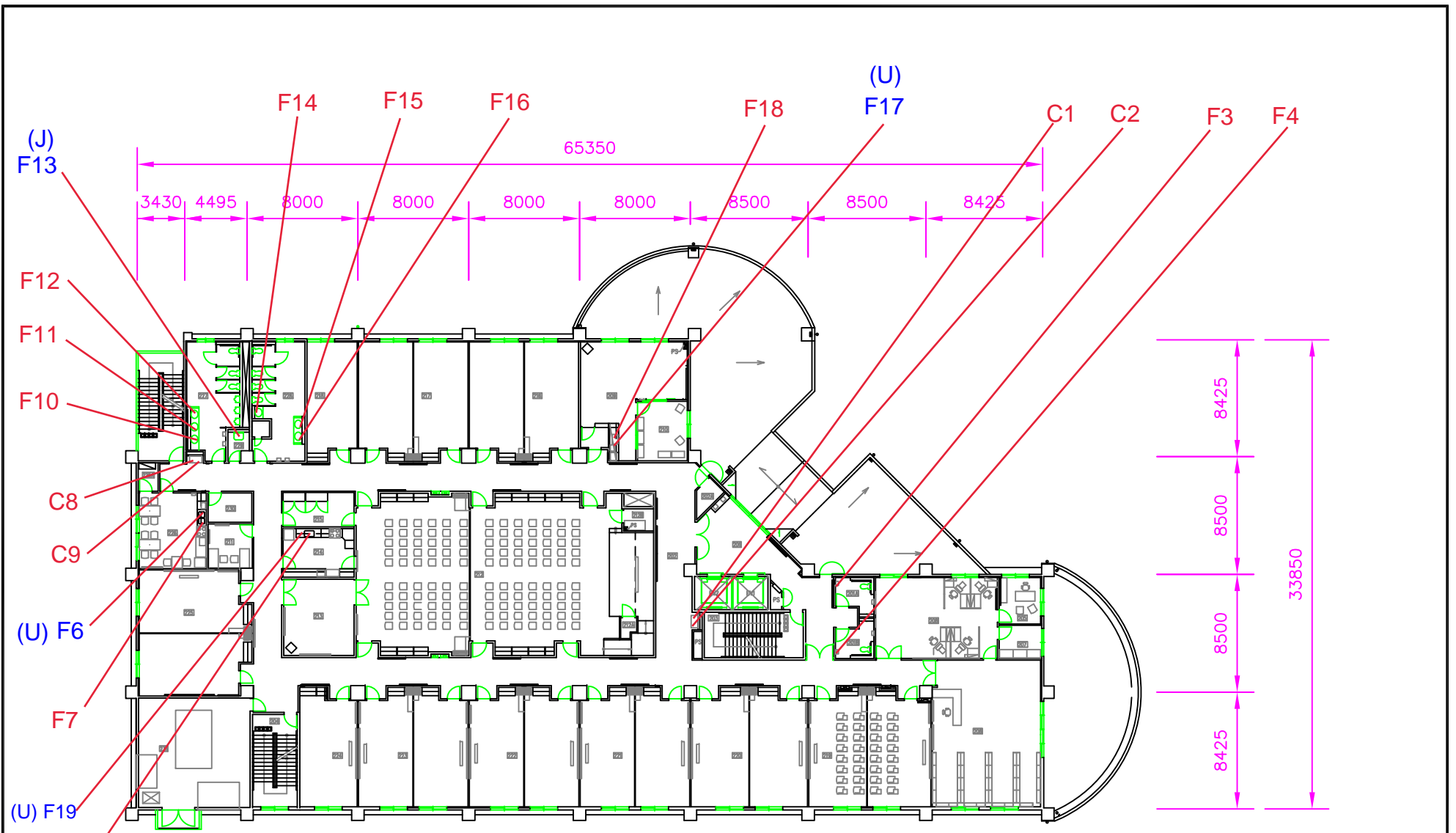

2ND FLOOR PLAN

| RM NO. | ROOM DESCRIPTION | RM NO. | ROOM DESCRIPTION | RM NO. | ROOM DESCRIPTION | RM NO. | ROOM DESCRIPTION | RM NO. | ROOM DESCRIPTION |
|--------|------------------------|--------|------------------------|--------|------------------------|--------|------------------|--------|-----------------------------|
| 201 | HALL LOBBY | 205 | OFFICE (E) | 215A | STORAGE (E) | 219 | CLASSROOM (4) | 228A | STORAGE (E) |
| 204A | MEN'S TOILET | 206 | OFFICE (C) | 218 | BOARD ROOM | 220 | CLASSROOM (5) | 227 | MEN'S TOILET (E) |
| 209 | MEN'S TOILET | 207 | FILES/COPY ROOM | 213 | CLASSROOM/READING ROOM | 221 | CLASSROOM (6) | 228 | WOMEN'S TOILET (E) |
| 202 | CORRIDOR | 208 | OFFICE (E) | 214 | RECEPTIONIST | 222 | CLASSROOM (7) | 229 | JANITORS CLOSET |
| 204A | TELECOMMUNICATION ROOM | 209 | CHAIRMAN ROOM | 215 | PREPARATION ROOM | 223 | CLASSROOM (8) | 230 | RECEPTIONIST ROOM |
| 203 | STAIRS (E) | 210 | GUEST ROOM | 216 | CLASSROOM (9) | 224 | CLASSROOM (9) | 231 | MECHANICAL ROOM (2nd FLOOR) |
| 204 | STAIRS (W) | 211 | OFFICE (C) | 217 | CLASSROOM (10) | 225 | OFFICE | | |
| 204 | STAIRS (W) | 212 | CLASSROOM (TELEVISION) | 218 | CLASSROOM (11) | 226 | BREAK ROOM | | |

Kinnick High School

(2nd Floor Community Readiness Center)

Samples will not be collected from following non-drinking outlets:
 J: Janitor
 U: Utility outlet for dishwasher

| | | |
|-------------|-----------------|--|
| TITLE | 3365 LIBRARY | Drawing by: tomitak Drawing Dt: 2008/04/11 |
| Scale 1/400 | Unit=mm | Last Modified by: PRY12, K.Tomita Date (yyyy/mm/dd): 2011/08/19 |