

Overview of Testing Results for Lead in Drinking Water and Corrective Actions for Naval Station Norfolk CDH (Building A58)

The Navy is committed to maintaining safe drinking water on its installations. City water supplied to the Navy and the Navy's water distribution system is regularly tested and in compliance with the Safe Drinking Water Act. Because lead exposure is a particular concern for children, and lead may be added to drinking water through the pipes, fittings, solder, and fixtures inside a building, the Environmental Protection Agency (EPA) recommends, but does not mandate, that we test the lead content of drinking water in priority areas such as youth centers (YCs), child development homes (CDHs), and child development centers (CDCs). The Navy has adopted the recommendation as policy.

Navy environmental personnel conducted lead testing at the Naval Station Norfolk CDH in accordance with Navy and EPA guidelines. Samples from various locations in the CDH were sent to a state-certified laboratory for analysis.

At the Naval Station Norfolk CDH, outlets used for drinking, cooking, and washing were tested. Out of 7 samples collected, no water outlets tested above the EPA-recommended screening level for lead in drinking water in schools and childcare centers of 20 parts per billion (ppb).

A copy of all test results is enclosed for your information. The test results are presented in two tables:

- Table 1 **Summary of Results** summarizes the data by category of use (e.g., drinking, cooking, washing).
- Table 2 **Summary Statistics** summarizes all the data.

A floor plan of the Naval Station Norfolk CDH has also been included to show the locations of the fixtures that were sampled.

Table 1 provides a description of each sampling location using three columns; *Category*, *Sampling ID*, and *Outlet Description*. The *Category* column gives information about whether the outlet is used for drinking water (water fountain), cooking (food preparation), or washing (primarily hand-washing or brushing teeth). The *Sample ID* column is the identification used to label each sample bottle. The *Outlet Description* column contains additional information to describe the outlet sampled under each category.

The next set of columns in **Table 1** provide *Initial Sampling Results*, and for those locations that exceeded the recommended screening level of 20 ppb the *Re-sampling Results*.

EPA sampling protocol requires water to not be used for between 8 and 18 hours prior to first draw sampling. Therefore, *Initial Sampling Results* were from first draw samples collected early in the morning before the CDH opened and before any water was used. The *Initial Sampling Results* also indicate whether resampling is required and the date that fixtures greater than 20 ppb were secured.

The *Re-sampling Results*, *Corrective Actions*, and *Post Remediation Sampling Results* columns are annotated N/A (not applicable) since all the samples at the Naval Station Norfolk CDH were within EPA recommended levels.

To learn more about lead in drinking water in schools and day care centers visit the following EPA website: <https://www.epa.gov/dwreginfo/lead-drinking-water-schools-and-child-care-facilities>.

To learn more about your home's public water supplier, see their annual water quality report: https://www.cnic.navy.mil/regions/cnrma/om/environmental_support/water_quality_information.html

To answer any questions you may have on the sampling program contact, please contact us at 757-677-6642. If you have any health questions or concerns, you are encouraged to contact your health care provider or, if you are a TRICARE beneficiary, use the Mid-Atlantic Appointment Center to schedule an appointment with your primary care provider at 1-866-645-4584.

Enclosures:

1. Complete Test Results
2. Floor Plan of the Naval Station Norfolk CDH

Table 1. Summary of Results

| SAMPLING LOCATION DESCRIPTION | | | | | INITIAL SAMPLING RESULTS | | | RE-SAMPLING RESULTS | | | CORRECTIVE ACTIONS | POST REMEDIATION SAMPLING | |
|-------------------------------|---------------|---------------------|--|----------|--------------------------|------------------|-----------------------|--|------------------|--|--------------------|---------------------------|--|
| CATEGORY | SAMPLE ID NO. | SAMPLE ID | Outlet Description | Comments | First Draw (ppb) | Retest required? | Date Fixture Secured? | Lead Screening Level of 20ppb | | | Description | Recommended Level = 20ppb | |
| | | | | | | | | Water Fountain 15 min. Follow up Flush Sample - Collected day before First Draw Sampling (ppb) | First Draw (ppb) | Follow up Flush - Collected 30 seconds after First Draw Sampling (ppb) | | First Draw (ppb) | Follow up Flush - Collected 30 seconds after First Draw Sampling (ppb) |
| SAMPLING DATE | | | | | 10/27/2017 | | | N/A | N/A | N/A | | N/A | |
| RESULTS DATE | | | | | 11/6/2017 | | | N/A | N/A | N/A | | N/A | |
| DRINKING | 10 | NS-A58-K-FRIDGE-FD | Water dispenser at the refrigerator in the Kitchen | | non-detect | No | N/A | N/A | N/A | N/A | N/A | N/A | N/A |
| COOKING | 9 | NS-A58-K-K-FD | Kitchen sink faucet used for food preparation and dishwashing in the Kitchen | | non-detect | No | N/A | N/A | N/A | N/A | N/A | N/A | N/A |
| WASHING | 1 | NS-A58-INFRM-HHW-FD | High handwashing faucet in the Infant Room | | non-detect | No | N/A | N/A | N/A | N/A | N/A | N/A | N/A |
| WASHING | 2 | NS-A58-ACTRM-HHW-FD | High handwashing faucet in the Activity Room | | 1 | No | N/A | N/A | N/A | N/A | N/A | N/A | N/A |
| WASHING | 3 | NS-A58-BATHA-HHW-FD | High handwashing faucet in Restroom A | | non-detect | No | N/A | N/A | N/A | N/A | N/A | N/A | N/A |
| WASHING | 5 | NS-A58-BATHB-HHW-FD | High handwashing faucet in Restroom B | | non-detect | No | N/A | N/A | N/A | N/A | N/A | N/A | N/A |
| WASHING | 7 | NS-A58-BATHC-HHW-FD | High handwashing faucet in Restroom C | | non-detect | No | N/A | N/A | N/A | N/A | N/A | N/A | N/A |

Table 2. Summary Statistics

| CATEGORY | INITIAL SAMPLING RESULTS | | RE-SAMPLING RESULTS | | | POST |
|-------------------------|--------------------------|--|--|------------------|--|------------------|
| | First Draw (ppb) | | Lead Screening Level of 20ppb | | | First Draw (ppb) |
| | | | Water Fountain Follow up Flush Sample - Collected day before First Draw Sampling (ppb) | First Draw (ppb) | Follow up Flush - Collected 30 seconds after First Draw Sampling (ppb) | |
| Total Drinking | 1 | | N/A | N/A | N/A | N/A |
| Total Drinking > 20 ppb | 0 | | N/A | N/A | N/A | N/A |
| Total Cooking | 1 | | N/A | N/A | N/A | N/A |
| Total Cooking > 20 ppb | 0 | | N/A | N/A | N/A | N/A |
| Total Washing | 5 | | N/A | N/A | N/A | N/A |
| Total Washing > 20 ppb | 0 | | N/A | N/A | N/A | N/A |
| Total Samples | 7 | | N/A | N/A | N/A | N/A |
| Total Samples > 20 ppb | 0 | | N/A | N/A | N/A | N/A |

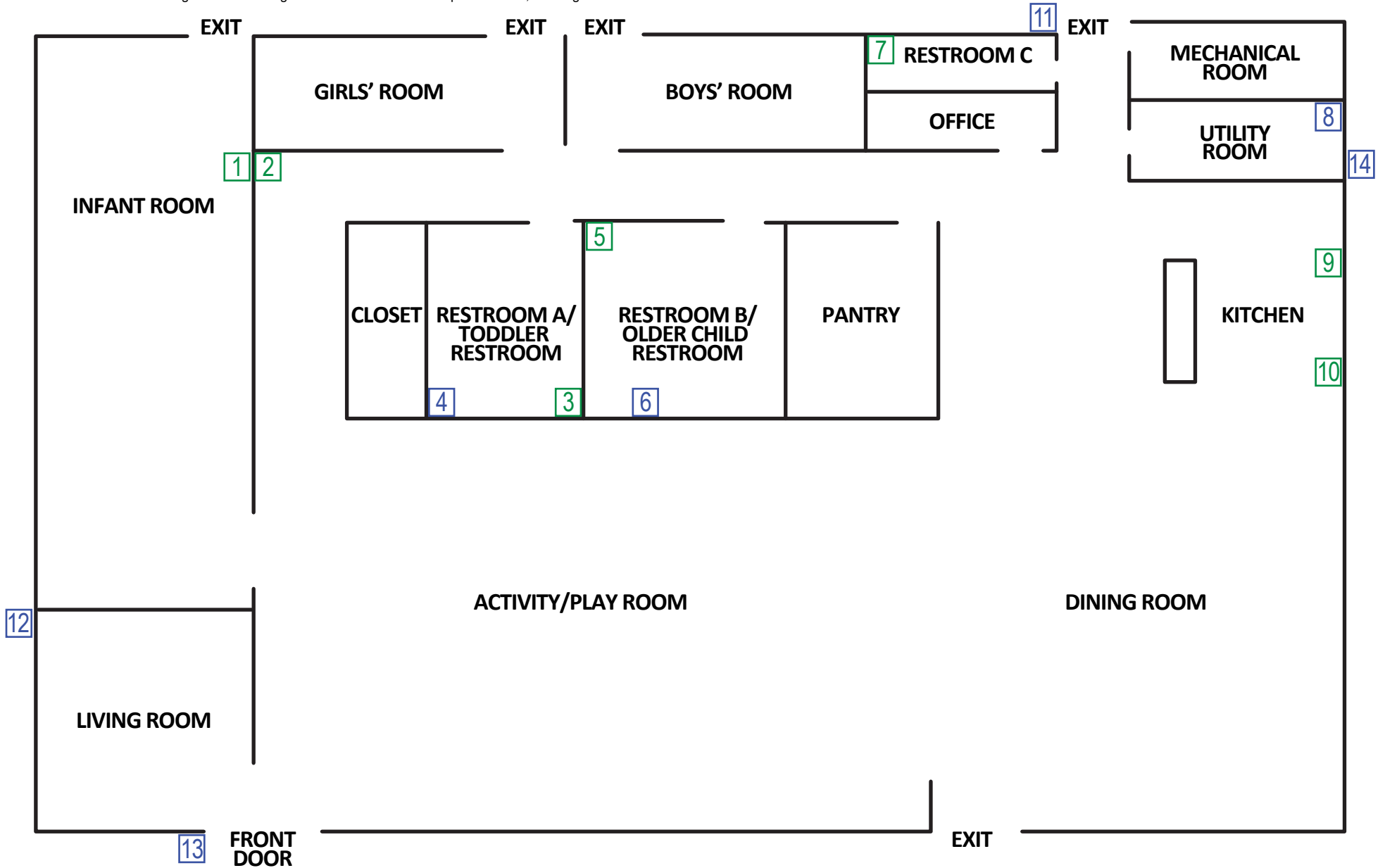

1 BUILDING A58 - FLOOR PLAN

NOT TO SCALE



Outlet numbers pertaining to the floor plan.
 Red = Above 20 ppb
 Green = Below 20 ppb
 Blue = Not Sampled

| No. | Type of Fixture | Location Description | Exceeded? |
|-----|--|---------------------------------|-------------|
| 1 | High handwashing faucet | Infant Room | No |
| 2 | High handwashing faucet | Activity Room | No |
| 3 | High handwashing faucet | Restroom A/Toddler Restroom | No |
| 4 | Bathtub faucet | Restroom A/Toddler Restroom | Not sampled |
| 5 | High handwashing faucet | Restroom B/Older Child Restroom | No |
| 6 | Bathtub faucet | Restroom B/Older Child Restroom | Not sampled |
| 7 | High handwashing faucet | Restroom C/Staff Restroom | No |
| 8 | Utility sink | Utility Room | Not sampled |
| 9 | Kitchen sink used for food preparation and dishwashing | Kitchen | No |
| 10 | Water dispenser from refrigerator | Kitchen | No |
| 11 | Hose bib | Outside | Not sampled |
| 12 | Hose bib | Outside | Not sampled |
| 13 | Hose bib | Outside | Not sampled |
| 14 | Hose bib | Outside | Not sampled |

Outlet numbers pertaining to the floor plan.
 Red = Above 20 ppb
 Green = Below 20 ppb
 Blue = Not Sampled