

Testing Results for Lead in Drinking Water for *SUBASENLON CDC (Buildings CT186, CT383 and CT386)*

The Navy is committed to maintaining safe drinking water on its installations. City water supplied to the Navy and the Navy's water distribution system is regularly tested and in compliance with the Safe Drinking Water Act. Because lead exposure is a particular concern for children, and lead may be added to drinking water through the pipes, fittings, solder, and fixtures inside a building, the EPA recommends, but does not mandate, that we test the lead content of drinking water in priority areas such as youth centers (YCs), child development group homes (CDGHs) and child development centers (CDCs).

Navy environmental personnel conducted lead testing at the *SUBASENLON CDC* in accordance with Navy and EPA guidelines. Samples from various locations in the CDC were sent to a state-certified laboratory for analysis.

At the *SUBASENLON CDC*, outlets used for drinking and cooking, as well as outlets used for hand washing were tested. Out of **81** samples collected, **4** water outlets initially tested above the EPA recommended level for lead in drinking water in schools and childcare centers of 20 parts per billion (ppb). One part per billion is equal to one drop of water in an Olympic-size swimming pool.

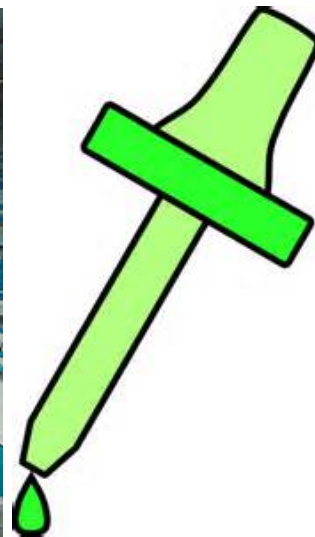

These four outlets were all located in CT186. Two of the outlets that exceeded the EPA recommended level of 20 ppb were hand washing sinks located in the bathroom of the Pre-School 1-1 classroom, which tested at 23 ppb and 35 ppb, respectively. Another hand washing sink in the bathroom of the Pre-Toddler 2-1 classroom tested at 79 ppb, however this classroom has not been used since June of 2013. The last outlet was a kitchen sink that has not been in use which tested at 20 ppb. All four of these outlets were secured and re-tested in accordance with established protocols, which involved removing any faucet aerators in use. A **faucet aerator** (or tap aerator) is often found at the tip of modern indoor water faucets. Without an aerator, water

usually flows out of a faucet as one big stream. An aerator spreads this stream into many little droplets, which helps save water and reduce splashing. However, the aerator and screen can trap debris which can accumulate lead.



After removing any faucet aerators, retesting showed that all the sinks except that one in the kitchen were below the EPA-recommended level. Although the kitchen sink was not in use, it was capped to ensure it is not used as a source of water. Aerators in the bathroom sinks in the Pre-School 1-1 classroom were replaced and the bathroom faucet in the Pre-Toddler 2-1 classroom was replaced.

A copy of all test results is enclosed for your information. The test results are presented in two tables:

- Table 1 **Summary of Results** summarizes the data by category of use (e.g., drinking, cooking, washing).
- Table 2 **Summary Statistics** summarizes all the data.

Floor plans of the *SUBASENLON CDC* Buildings have also been included to show the locations of the fixtures.

Table 1 provides a description of each sampling location using three columns; *Category*, *Sampling ID*, and *Outlet Description*. The *Category* column gives information about whether the outlet is used for drinking water (water fountain), cooking (food preparation), or washing (primarily hand-washing). The *Sample ID* column is the identification used to label each sample bottle. The *Outlet Description* column contains additional information to describe the outlet sampled under each category.

The next set of columns in **Table 1** provide *Initial Sampling Results*, and for those locations that exceeded the recommended level of 20 ppb the *Re-sampling Results*.

EPA sampling protocol requires water to not be used for between 8 and 18 hours prior to first draw sampling. Therefore, *Initial Sampling Results were from* first draw samples collected early in the morning before the CDC opened and before any water was used. The *Initial Sampling Results* also indicate whether resampling is required and the date that fixtures greater than 20 ppb were secured. Outlets that exceeded 20 ppb are highlighted in yellow.

The *Re-sampling Results* includes columns for *First Draw* and flushing samples which help determine the source of lead. For cooking and washing outlets, aerators were removed before retesting:

- If the lead concentration of 30 second flush sample resulted in lower than 20 ppb lead, the aerators were the source of lead and the outlet can be used for drinking if the aerators are cleaned or replaced. The hand washing sinks in Pre-School 1-1 fit in this category.
- If the lead concentration of the resampled first draw (but not the follow up 30 second flush) was greater than 20 ppb, the fixture was the source of lead. These fixtures can be used if water is flushed for 30 seconds before first use of the day or if the fixtures are replaced and retesting confirms that the new fixtures do not leach lead. The kitchen sink in CT186 fits in this category. This sink was removed from service.
- If the lead concentration of the 30 second flush sample was greater than 20 ppb and greater than the lead concentration of the first draw resample, the source of lead is the plumbing upstream of the outlet. These outlets should be disconnected unless upstream plumbing is replaced. No outlets fit this category.

The *Corrective Actions* column describes actions that were taken to remediate the source of lead.

To learn more about lead in drinking water schools and day care centers visit this EPA website at: http://water.epa.gov/drink/info/lead/schools_index.cfm.

To answer any questions you may have on the sampling program contact the SUBASENLON Public Affairs Officer at 860-694-5684.

Priority Areas Lead Testing and Corrective Actions (OCTOBER 2013)
SUBASENLON, Child Development Center
CT186, CT383, CT386

Table 1. Summary of Results

SAMPLING LOCATION DESCRIPTION					INITIAL SAMPLING RESULTS			RE-SAMPLING RESULTS			CORRECTIVE ACTIONS	POST REMEDIATION SAMPLING	
CATEGORY Water Intended For:	BUILDING	ROOM	SAMPLE ID	Outlet Description	First Draw (ppb)	Retest required?	Date Fixture Secured? (See Note 1)	Water Fountain 15 min. Follow up Flush Sample - Collected day before First Draw Sampling	First Draw (ppb)	Follow up Flush - Collected 30 seconds after First Draw Sampling (ppb)	Description	Recommended Level = 20ppb	
												First Draw (ppb) (See note 2)	Follow up Flush - Collected 30 seconds after First Draw Sampling (ppb)
					Detection Limit = 1 ppb				Detection Limit = 1 ppb	Detection Limit = 1 ppb		Detection Limit = 1 ppb	Detection Limit = 1 ppb
				SAMPLING DATE ---->	10/22/2013				NA	10/26/2013	10/26/2013		12/5/2013
				RESULTS DATE ---->	10/24/2013				NA	10/29/2013	10/29/2013		12/9/2013
DRINKING	CT386	PRETODDLER 16	NL-CT386-RMPT16-WFCOMB-FD	CLASSROOM SINK	5.7	NO	NA	NA	NA	NA	Routine Control Measures Only		
DRINKING	CT383	HALLWAY	NL-CT383-HW-WFC-FD	WATER FOUNTAIN COOLER	1	NO	NA	NA	NA	NA	Routine Control Measures Only		
DRINKING	CT383	PRESCHOOL 1-4	NL-CT383-RMPS14-WFCOMB(A)-FD	CLASSROOM SINK	1	NO	NA	NA	NA	NA	Routine Control Measures Only		
DRINKING	CT383	PRESCHOOL 1-4	NL-CT383-RMPS14-WFCOMB(B)-FD	CLASSROOM SINK	1	NO	NA	NA	NA	NA	Routine Control Measures Only		
DRINKING	CT383	TODDLER 2-4	NL-CT383-RMTD24-WFCOMB-FD	CLASSROOM SINK	2.1	NO	NA	NA	NA	NA	Routine Control Measures Only		
DRINKING	CT383	PRESCHOOL 2-4	NL-CT383-RMPS24-WFCOMB(A)-FD	CLASSROOM SINK	1	NO	NA	NA	NA	NA	Routine Control Measures Only		
DRINKING	CT383	PRESCHOOL 2-4	NL-CT383-RMPS24-WFCOMB(B)-FD	CLASSROOM SINK	1.6	NO	NA	NA	NA	NA	Routine Control Measures Only		
DRINKING	CT383	TODDLER 1-4	NL-CT383-RMTD14-WFCOMB-FD	CLASSROOM SINK	1	NO	NA	NA	NA	NA	Routine Control Measures Only		
DRINKING	CT386	TODDLER 19	NL-CT386-RMTD19-WFCOMB-FD	CLASSROOM SINK	2.3	NO	NA	NA	NA	NA	Routine Control Measures Only		
DRINKING	CT386	TODDLER 18	NL-CT386-RMTD18-WFCOMB-FD	CLASSROOM SINK	1	NO	NA	NA	NA	NA	Routine Control Measures Only		
DRINKING	CT386	HALLWAY	NL-CT386-HW-WFC-FD	WATER FOUNTAIN COOLER	1	NO	NA	NA	NA	NA	Routine Control Measures Only		
COOKING	CT186	KITCHEN	NL-CT186-K-HWCOMB-FD	KITCHEN SINK	20	YES	10/25/2013	NA	52	1	Sink Taken Off-Line And Secured		
COOKING	CT383	KITCHEN	NL-CT383-K-K(A)-FD	KITCHEN SINK	1	NO	NA	NA	NA	NA	Routine Control Measures Only		
COOKING	CT383	KITCHEN	NL-CT383-K-K(B)-FD	KITCHEN SINK	1	NO	NA	NA	NA	NA	Routine Control Measures Only		
COOKING	CT383	KITCHEN	NL-CT383-K-K(C)-FD	KITCHEN SINK	1	NO	NA	NA	NA	NA	Routine Control Measures Only		
COOKING	CT386	KITCHEN	NL-CT386-K-K(A)-FD	KITCHEN SINK	1	NO	NA	NA	NA	NA	Routine Control Measures Only		
COOKING	CT386	KITCHEN	NL-CT386-K-K(B)-FD	KITCHEN SINK	2.6	NO	NA	NA	NA	NA	Routine Control Measures Only		
COOKING	CT386	KITCHEN	NL-CT386-K-K(C)-FD	KITCHEN SINK	3.8	NO	NA	NA	NA	NA	Routine Control Measures Only		
WASHING	CT186	PRETODDLER 1-1	NL-CT186-RMPT11-HHW-FD	CLASSROOM SINK	1.7	NO	NA	NA	NA	NA	Routine Control Measures Only		
WASHING	CT186	PRETODDLER 1-1	NL-CT186-RMPT11-LHW-FD	CLASSROOM SINK	10	NO	NA	NA	NA	NA	Replaced Aerator		
WASHING	CT186	PRETODDLER 2-1	NL-CT186-BATHPT21-HHW-FD	BATHROOM SINK	1.2	NO	NA	NA	NA	NA	Routine Control Measures Only		
WASHING	CT186	PRETODDLER 2-1	NL-CT186-BATHPT21-LHW(A)-FD	BATHROOM SINK	79	YES	10/25/2013	NA	2	1	Replaced Faucet	1	1
WASHING	CT186	PRETODDLER 2-1	NL-CT186-BATHPT21-LHW(B)-FD	BATHROOM SINK	2.8	NO	NA	NA	NA	NA	Routine Control Measures Only		
WASHING	CT186	PRETODDLER 2-1	NL-CT186-BATHPT21-LHW(C)-FD	BATHROOM SINK	16	NO	NA	NA	NA	NA	Replaced Aerator		
WASHING	CT186	PRETODDLER 2-1	NL-CT186-BATHPT21-LHW(D)-FD	BATHROOM SINK	4.5	NO	NA	NA	NA	NA	Routine Control Measures Only		

Priority Areas Lead Testing and Corrective Actions (OCTOBER 2013)
SUBASENLON, Child Development Center
CT186, CT383, CT386

Table 1. Summary of Results

SAMPLING LOCATION DESCRIPTION					INITIAL SAMPLING RESULTS			RE-SAMPLING RESULTS			CORRECTIVE ACTIONS	POST REMEDIATION SAMPLING	
CATEGORY Water Intended For:	BUILDING	ROOM	SAMPLE ID	Outlet Description	First Draw (ppb)	Retest required?	Date Fixture Secured? (See Note 1)	Water Fountain 15 min. Follow up Flush Sample - Collected day before First Draw Sampling	First Draw (ppb)	Follow up Flush - Collected 30 seconds after First Draw Sampling (ppb)		Description	Recommended Level = 20ppb
											First Draw (ppb)		Follow up Flush (ppb)
SAMPLING DATE ---->					10/22/2013								12/5/2013
RESULTS DATE ---->					10/24/2013								12/9/2013
WASHING	CT186	PRETODDLER 2-1	NL-CT186-RMPT21-HHW-FD	CLASSROOM SINK	2.1	NO	NA	NA	NA	NA	Routine Control Measures Only		
WASHING	CT186	TODDLER 1-1	NL-CT186-BATHD11-HHW-FD	BATHROOM SINK	4.7	NO	NA	NA	NA	NA	Routine Control Measures Only		
WASHING	CT186	TODDLER 1-1	NL-CT186-BATHD11-LHW(A)-FD	BATHROOM SINK	4.2	NO	NA	NA	NA	NA	Routine Control Measures Only		
WASHING	CT186	TODDLER 1-1	NL-CT186-BATHD11-LHW(B)-FD	BATHROOM SINK	5.5	NO	NA	NA	NA	NA	Routine Control Measures Only		
WASHING	CT186	ADULT BATH	NL-CT186-BATH-HHW-FD	STAFF BATHROOM SINK	7.3	NO	NA	NA	NA	NA	Routine Control Measures Only		
WASHING	CT186	PRESCHOOL 2-1	NL-CT186-BATHPS21-LHW(A)-FD	BATHROOM SINK	6	NO	NA	NA	NA	NA	Routine Control Measures Only		
WASHING	CT186	PRESCHOOL 2-1	NL-CT186-BATHPS21-LHW(B)-FD	BATHROOM SINK	13	NO	NA	NA	NA	NA	Replaced Aerator		
WASHING	CT186	PRESCHOOL 2-1	NL-CT186-RMPS21-HHW-FD	CLASSROOM SINK	9.5	NO	NA	NA	NA	NA	Routine Control Measures Only		
WASHING	CT186	PRESCHOOL 1-1	NL-CT186-BATHPS11-LHW(A)-FD	BATHROOM SINK	35	YES	10/25/2013	NA	10	1	Replaced Aerator		
WASHING	CT186	PRESCHOOL 1-1	NL-CT186-BATHPS11-LHW(B)-FD	BATHROOM SINK	23	YES	10/25/2013	NA	17	1	Replaced Aerator		
WASHING	CT383	INFANT 1-4	NL-CT383-RMIN14-HHW(A)-FD	CLASSROOM SINK	1.5	NO	NA	NA	NA	NA	Routine Control Measures Only		
WASHING	CT383	INFANT 1-4	NL-CT383-RMIN14-HHW(B)-FD	CLASSROOM SINK	1	NO	NA	NA	NA	NA	Routine Control Measures Only		
WASHING	CT383	ADULT BATH	NL-CT383-BATH-HHW-FD	STAFF BATHROOM SINK	1	NO	NA	NA	NA	NA	Routine Control Measures Only		
WASHING	CT383	LAUNDRY	NL-CT383-UT-HHW-FD	LAUNDRY ROOM SINK	1	NO	NA	NA	NA	NA	Routine Control Measures Only		
WASHING	CT383	STAFF LOUNGE	NL-CT383-LOUNGE-HHW-FD	STAFF LOUNGE	1	NO	NA	NA	NA	NA	Routine Control Measures Only		
WASHING	CT383	PRESCHOOL 1-4	NL-CT383-BATHPS14-LHW-FD	BATHROOM SINK	1	NO	NA	NA	NA	NA	Routine Control Measures Only		
WASHING	CT383	PRESCHOOL 1-4	NL-CT383-RMPS14-HHW-FD	CLASSROOM SINK	1	NO	NA	NA	NA	NA	Routine Control Measures Only		
WASHING	CT383	PRESCHOOL 1-4	NL-CT383-RMPS14-HWCMB(A)-FD	CLASSROOM SINK	1	NO	NA	NA	NA	NA	Routine Control Measures Only		
WASHING	CT383	PRESCHOOL 1-4	NL-CT383-RMPS14-HWCMB(B)-FD	CLASSROOM SINK	1	NO	NA	NA	NA	NA	Routine Control Measures Only		
WASHING	CT383	TODDLER 2-4	NL-CT383-BATHD24-LHW-FD	BATHROOM SINK	1	NO	NA	NA	NA	NA	Routine Control Measures Only		
WASHING	CT383	TODDLER 2-4	NL-CT383-RMTD24-HHW-FD	CLASSROOM SINK	1	NO	NA	NA	NA	NA	Routine Control Measures Only		
WASHING	CT383	TODDLER 2-4	NL-CT383-RMTD24-HWCMB-FD	CLASSROOM SINK	1	NO	NA	NA	NA	NA	Routine Control Measures Only		
WASHING	CT383	PRESCHOOL 2-4	NL-CT383-BATHPS24-LHW-FD	BATHROOM SINK	1	NO	NA	NA	NA	NA	Routine Control Measures Only		
WASHING	CT383	PRESCHOOL 2-4	NL-CT383-RMPS24-HHW-FD	CLASSROOM SINK	1	NO	NA	NA	NA	NA	Routine Control Measures Only		
WASHING	CT383	PRESCHOOL 2-4	NL-CT383-RMPS24-HWCMB(A)-FD	CLASSROOM SINK	1	NO	NA	NA	NA	NA	Routine Control Measures Only		
WASHING	CT383	PRESCHOOL 2-4	NL-CT383-RMPS24-HWCMB(B)-FD	CLASSROOM SINK	1	NO	NA	NA	NA	NA	Routine Control Measures Only		
WASHING	CT383	TODDLER 1-4	NL-CT383-BATHD14-LHW-FD	BATHROOM SINK	1	NO	NA	NA	NA	NA	Routine Control Measures Only		
WASHING	CT383	TODDLER 1-4	NL-CT383-RMTD14-HHW-FD	CLASSROOM SINK	1	NO	NA	NA	NA	NA	Routine Control Measures Only		
WASHING	CT383	TODDLER 1-4	NL-CT383-RMTD14-HWCMB-FD	CLASSROOM SINK	1	NO	NA	NA	NA	NA	Routine Control Measures Only		
WASHING	CT386	TODDLER 19	NL-CT386-BATHD19-LHW(A)-FD	BATHROOM SINK	1	NO	NA	NA	NA	NA	Routine Control Measures Only		
WASHING	CT386	TODDLER 19	NL-CT386-BATHD19-LHW(B)-FD	BATHROOM SINK	1.4	NO	NA	NA	NA	NA	Routine Control Measures Only		
WASHING	CT386	TODDLER 19	NL-CT386-RMTD19-HHW-FD	CLASSROOM SINK	1	NO	NA	NA	NA	NA	Routine Control Measures Only		
WASHING	CT386	TODDLER 19	NL-CT386-RMTD19-HWCMB-FD	CLASSROOM SINK	1	NO	NA	NA	NA	NA	Routine Control Measures Only		
WASHING	CT386	INFANT 12	NL-CT386-RMIN12-HHW(A)-FD	CLASSROOM SINK	1	NO	NA	NA	NA	NA	Routine Control Measures Only		
WASHING	CT386	INFANT 13	NL-CT386-RMIN13-HHW-FD	CLASSROOM SINK	1	NO	NA	NA	NA	NA	Routine Control Measures Only		
WASHING	CT386	INFANT 14	NL-CT386-RMIN14-HHW(A)-FD	CLASSROOM SINK	1.3	NO	NA	NA	NA	NA	Routine Control Measures Only		
WASHING	CT386	INFANT 14	NL-CT386-RMIN14-HHW(B)-FD	CLASSROOM SINK	1	NO	NA	NA	NA	NA	Routine Control Measures Only		
WASHING	CT386	PRETODDLER 16	NL-CT386-BATHPT16-LHW-FD	BATHROOM SINK	1	NO	NA	NA	NA	NA	Routine Control Measures Only		
WASHING	CT386	PRETODDLER 17	NL-CT386-BATHPT17-LHW-FD	BATHROOM SINK	1	NO	NA	NA	NA	NA	Routine Control Measures Only		
WASHING	CT386	PRETODDLER 17	NL-CT386-RMPT17-HHW-FD	CLASSROOM SINK	1	NO	NA	NA	NA	NA	Routine Control Measures Only		
WASHING	CT386	TODDLER 18	NL-CT386-BATHD18-LHW(A)-FD	BATHROOM SINK	1	NO	NA	NA	NA	NA	Routine Control Measures Only		
WASHING	CT386	TODDLER 18	NL-CT386-BATHD18-LHW(B)-FD	BATHROOM SINK	1	NO	NA	NA	NA	NA	Routine Control Measures Only		
WASHING	CT386	TODDLER 18	NL-CT386-RMTD18-HWCMB-FD	CLASSROOM SINK	1	NO	NA	NA	NA	NA	Routine Control Measures Only		

Priority Areas Lead Testing and Corrective Actions (OCTOBER 2013)
SUBASENLON, Child Development Center
CT186, CT383, CT386

Table 1. Summary of Results

SAMPLING LOCATION DESCRIPTION					INITIAL SAMPLING RESULTS			RE-SAMPLING RESULTS			CORRECTIVE ACTIONS	POST REMEDIATION SAMPLING	
CATEGORY Water Intended For:	BUILDING	ROOM	SAMPLE ID	Outlet Description	First Draw (ppb)	Retest required?	Date Fixture Secured? (See Note 1)	Water Fountain 15 min. Follow up Flush Sample - Collected day before First Draw Sampling	First Draw (ppb)	Follow up Flush - Collected 30 seconds after First Draw Sampling (ppb)		Description	Recommended Level = 20ppb
											First Draw (ppb) (See note 2)		Follow up Flush - Collected 30 seconds after First Draw Sampling (ppb)
					Detection Limit = 1 ppb				Detection Limit = 1 ppb	Detection Limit = 1 ppb		Detection Limit = 1 ppb	Detection Limit = 1 ppb
SAMPLING DATE ---->					10/22/2013				NA	10/26/2013	10/26/2013		12/5/2013
RESULTS DATE ---->					10/24/2013				NA	10/29/2013	10/29/2013		12/9/2013
WASHING	CT386	ADULT BATH	NL-CT386-BATH-HHW-FD	STAFF BATHROOM SINK	1	NO	NA	NA	NA	NA	Routine Control Measures Only		
WASHING	CT386	INFANT 11	NL-CT386-RMIN11-HHW-FD	CLASSROOM SINK	1	NO	NA	NA	NA	NA	Routine Control Measures Only		
WASHING	CT386	INFANT 12	NL-CT386-RMIN12-HHW(B)-FD	CLASSROOM SINK	1	NO	NA	NA	NA	NA	Routine Control Measures Only		
WASHING	CT386	LAUNDRY	NL-CT386-UT-HHW-FD	LAUNDRY ROOM SINK	2.2	NO	NA	NA	NA	NA	Routine Control Measures Only		
WASHING	CT386	STAFF LOUNGE	NL-CT386-LOUNGE-HHW-FD	LOUNGE SINK	1	NO	NA	NA	NA	NA	Routine Control Measures Only		
WASHING	CT386	PRETODDLER 16	NL-CT386-RMPT16-HWCOMB-FD	CLASSROOM SINK	1	NO	NA	NA	NA	NA	Routine Control Measures Only		
WASHING	CT386	PRETODDLER 17	NL-CT386-RMPT17-HWCOMB-FD	CLASSROOM SINK	1.9	NO	NA	NA	NA	NA	Routine Control Measures Only		
OUTDOOR	CT186	OUTSIDE	NL-CT186-ESB-SP-FD	OUTDOOR SPIGOT	7.9	NO	NA	NA	NA	NA	Routine Control Measures Only		
OUTDOOR	CT383	OUTSIDE	NL-CT383-ESB-SP-FD	OUTDOOR SPIGOT	18	NO	NA	NA	NA	NA	Replaced Aerator		
OUTDOOR	CT383	OUTSIDE	NL-CT383-NSB-SP-FD	OUTDOOR SPIGOT	4.2	NO	NA	NA	NA	NA	Routine Control Measures Only		
OUTDOOR	CT383	OUTSIDE	NL-CT383-WSB-SP-FD	OUTDOOR SPIGOT	4.3	NO	NA	NA	NA	NA	Routine Control Measures Only		
OUTDOOR	CT386	OUTSIDE	NL-CT386-ESB-SP-FD	OUTDOOR SPIGOT	16	NO	NA	NA	NA	NA	Replaced Aerator		
OUTDOOR	CT386	OUTSIDE	NL-CT386-WSB-SP-FD	OUTDOOR SPIGOT	7.2	NO	NA	NA	NA	NA	Routine Control Measures Only		

Notes:

¹ Affected outlets were immediately secured after receiving verbal communication from the lab on results exceeding the recommended level of 20ppb.

² Post-remediation sampling was initially conducted on [ENTER DATE]. Additional [CORRECTIVE ACTIONS DESCRIPTION] were implemented and final results below recommended level of 20ppb for sample collected on [ENTER DATE] are shown on the table.

Table 2. Summary Statistics

CATEGORY	INITIAL SAMPLING RESULTS	RE-SAMPLING RESULTS (For Samples >20 ppb)			POST REMEDIATION RESULTS
	Sample Date: 10/22/2013	Sample Date: 10/26/2013			
	First Draw	First Draw > 20 ppb	Water Fountain Follow up Flush Sample- Collected day before First Draw Sampling	Follow up Flush Collected 30 seconds after First Draw Sampling > 20 ppb	First Draw > 20 ppb
Total Drinking	11	0	0	0	0
Total Drinking > 20 ppb	0	0	0	0	0
Total Cook/Brush	7	1	0	1	0
Total Cook/Brush > 20 ppb	1	1	0	0	0
Total Washing	57	3	0	3	0
Total Washing > 20 ppb	3	0	0	0	0
Outdoor	6	0	0	0	0
Outdoor > 20 ppb	0	0	0	0	0
Total Samples	81	4	0	4	0
Total Samples > 20 ppb	4	1	0	0	0

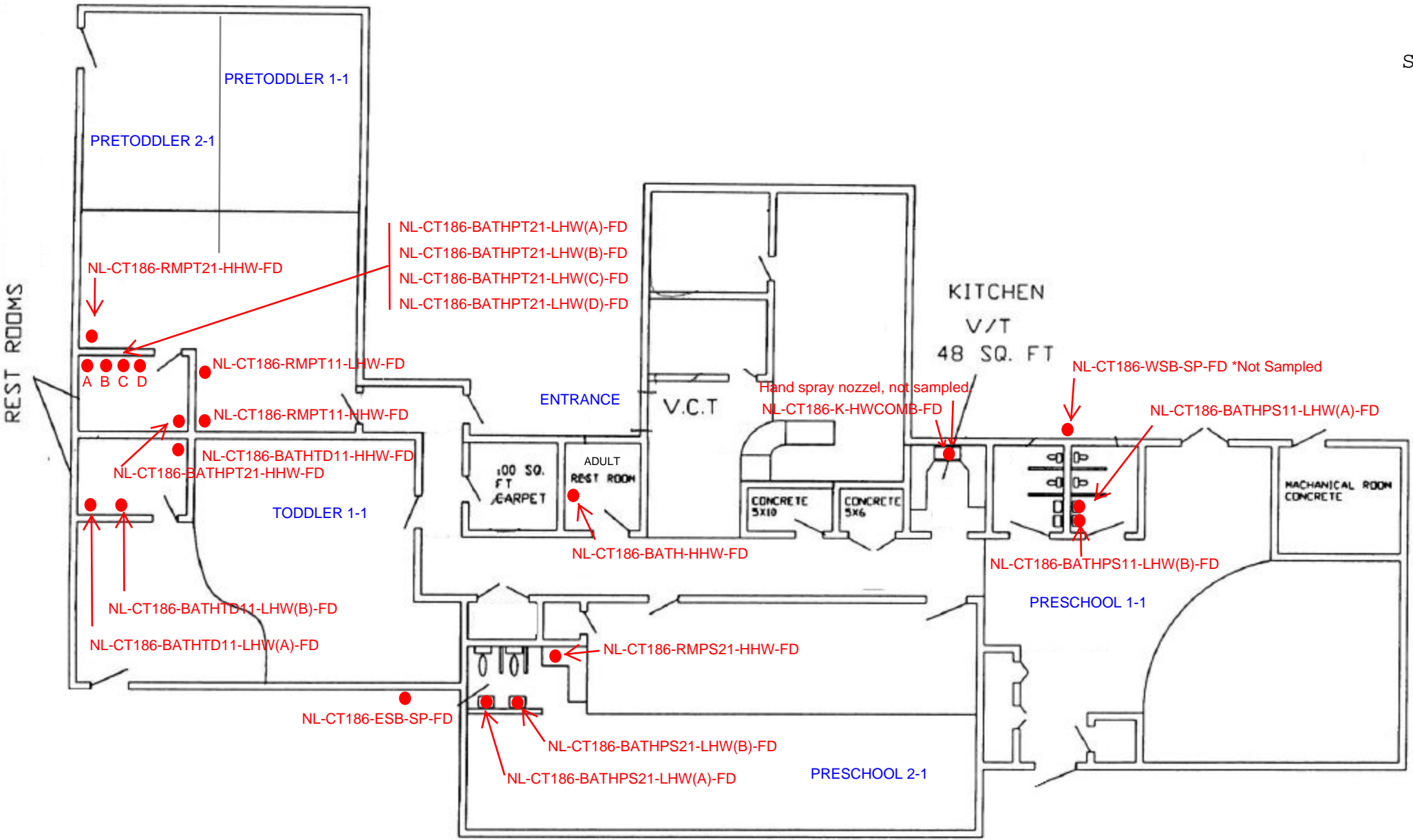
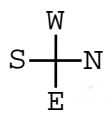

B-CT. 186 CHILD CARE CENTER
NO-SCALE 8/00 J.T.B

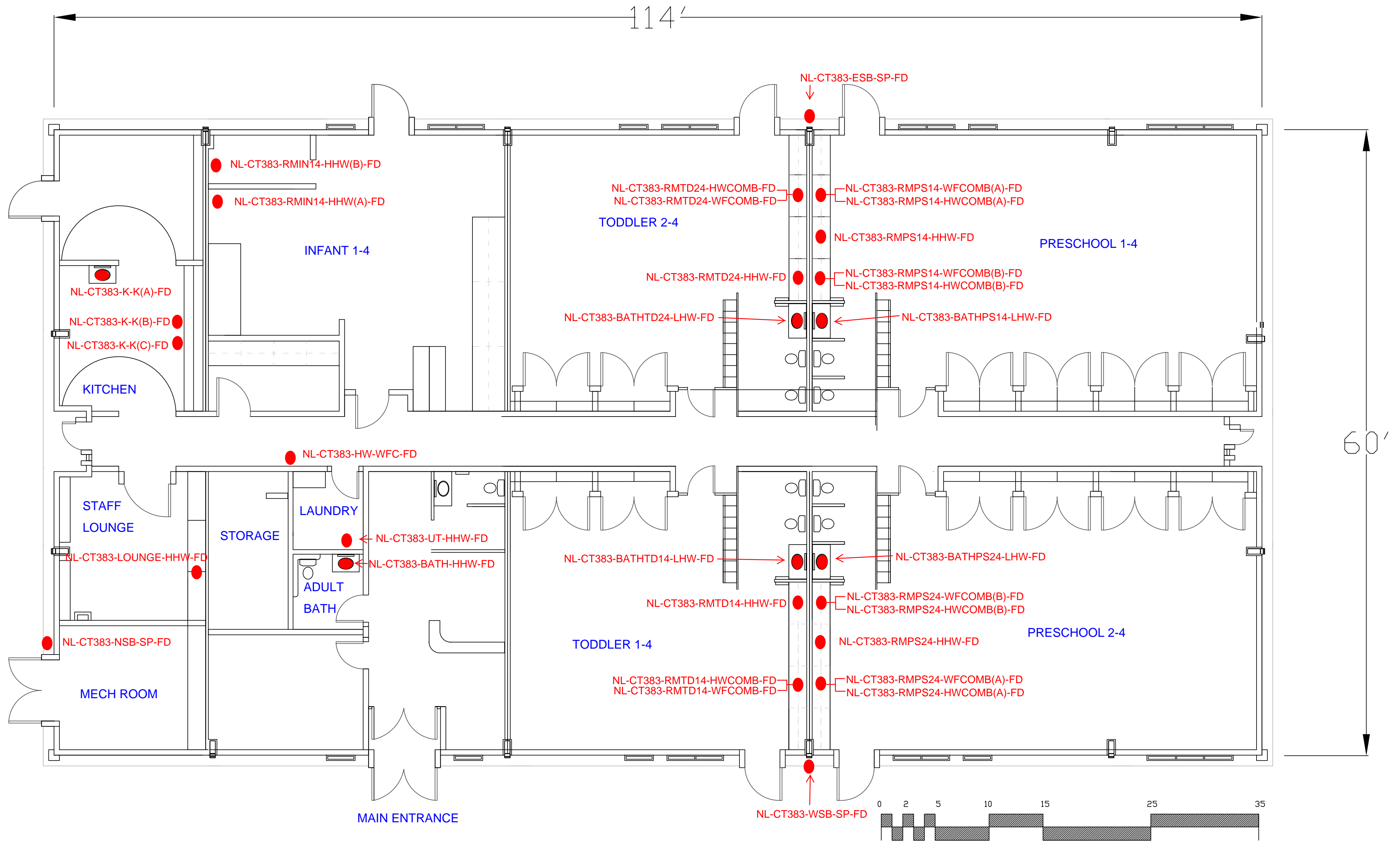
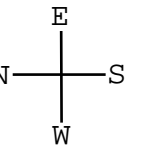

Child Development Center - CT-383

NL-CT386-WSB-SP-FD

NL-CT386-K-K(A)-FD



Kitchen
NL-CT386-K-K(B)-FD
NL-CT386-K-K(C)-FD
*Dishwashing spray nozzle, not sampled.

Toddler B, 19.

Toddler A, 18

Pretoddler B 17

Pretoddler A 16

NL-CT386-RMTD19-HWCOMB-FD
NL-CT386-RMTD19-WFCOMB-FD

NL-CT386-RMTD18-WFCOMB-FD
NL-CT386-RMTD18-HWCOMB-FD

NL-CT386-RMPT17-HWCOMB-FD
W.F. Flow Too Low To Sample
NL-CT386-RMPT17-HHW-FD

NL-CT386-PT16-WFCOMB-FD
NL-CT386-PT16-HW-COMB-FD

NL-CT386-RMTD19-HHW-FD

NL-CT386-RMTD18-WFCOMB-FD
NL-CT386-RMTD18-HWCOMB-FD

NL-CT386-BATHPT17-LHW-FD

NL-CT386-BATHPT16-LHW-FD

NL-CT386-BATHTD19-LHW(A)-FD

NL-CT386-BATHTD18-LHW(A)-FD

NL-CT386-BATHTD19-LHW(B)-FD

NL-CT386-BATHTD18-LHW(B)-FD

NL-CT386-UT-HHW-FD

EXIT TO

CT 186

NL-CT386-RMIN14-HHW(A)-FD

NL-CT386-RMIN13-HHW-FD

NL-CT386-RMIN12-HHW(A)-FD

NL-CT386-RMIN11-HHW-FD

NL-CT386-HW-WFC-FD

NL-CT386-BATH-HHW-FD

NL-CT386-RMIN14-HHW(B)-FD

NL-CT386-RMIN12-HHW(B)-FD

NL-CT386-LOUNGE-HHW-FD

NL-CT386-ESB-SP-FD

Infant D
14

Infant C
13

Infant B
12

Infant A
11

Conference Room

Lobby/Reception

Bathroom
ADULT

Laundry

Office

Office

Entrance

Lounge

CT-386

